

iPad Printing

With proper configuration, iPads can print to Taylor printers. Printing from other devices may not be possible. This tutorial describes the process for configuring an iPad for printing to a Taylor printer.

Installing the PaperCut client for iPad

- Click the link: <https://print.campus.tayloru.edu:9192/ios/install>
- Press Install

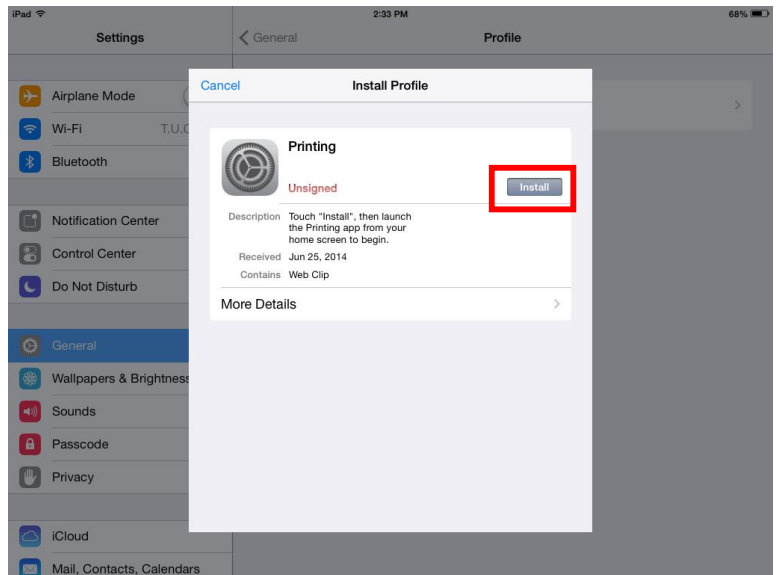

- Press Install Now

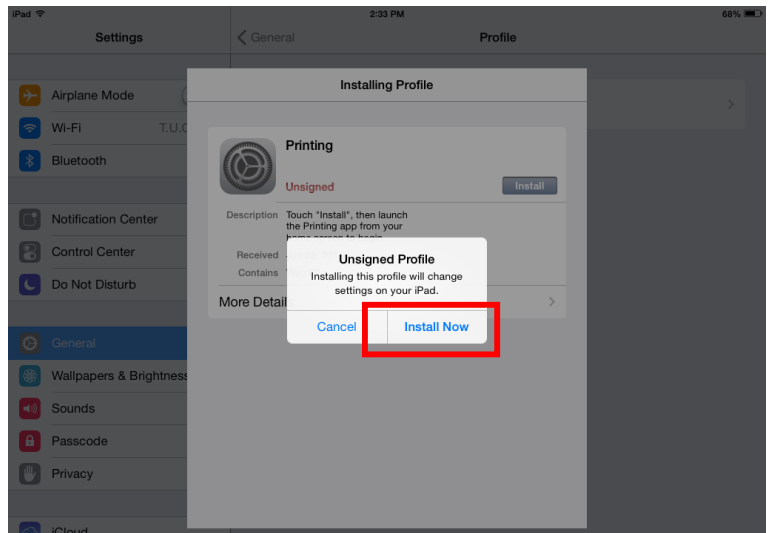

➤ Press Done

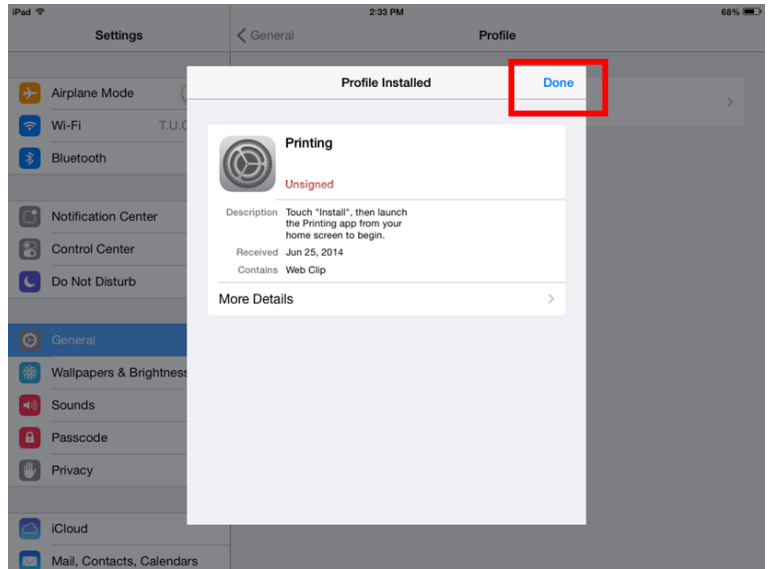

➤ Close this screen if it appears - you are not logged in

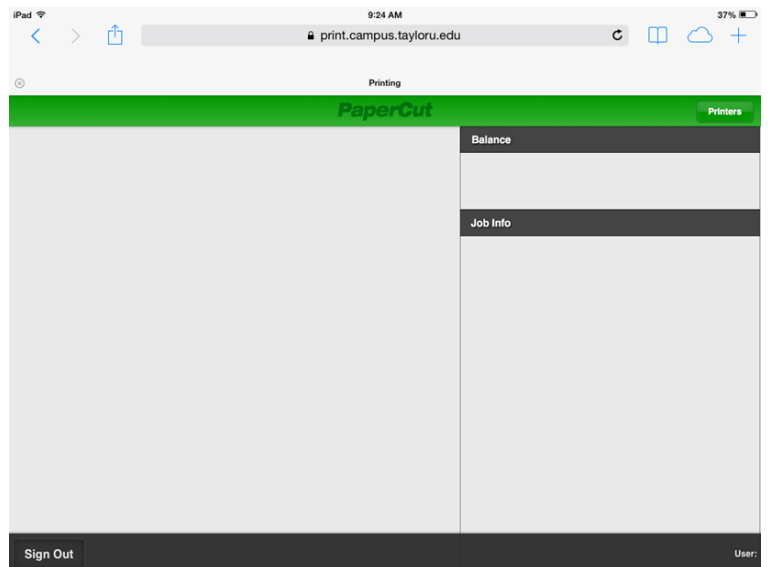

➤ Close this screen if it appears - the App is not connecting

➤ Wait 30 seconds

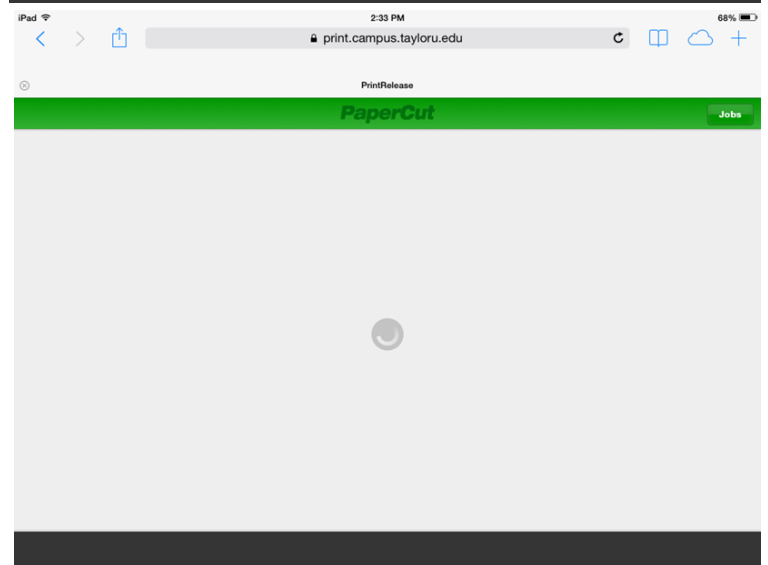

Printing using the PaperCut client for iPad

- Launch the PaperCut Application

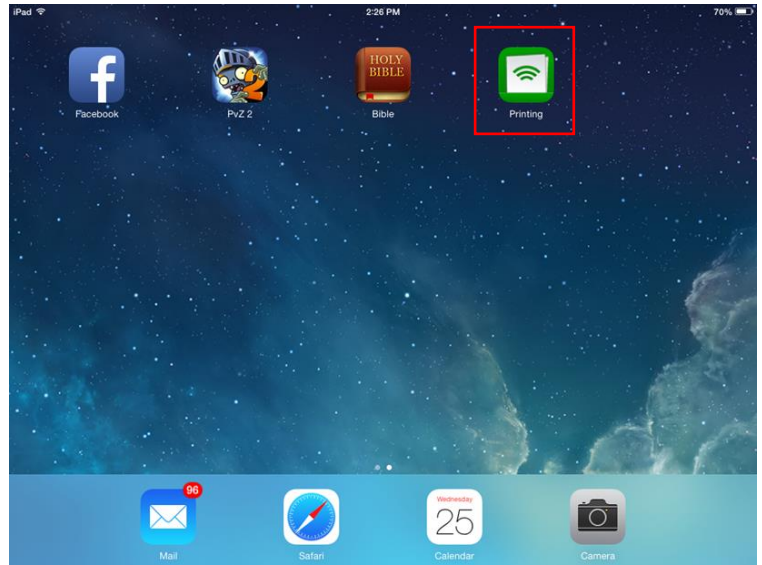

- Log in with your Taylor username and password

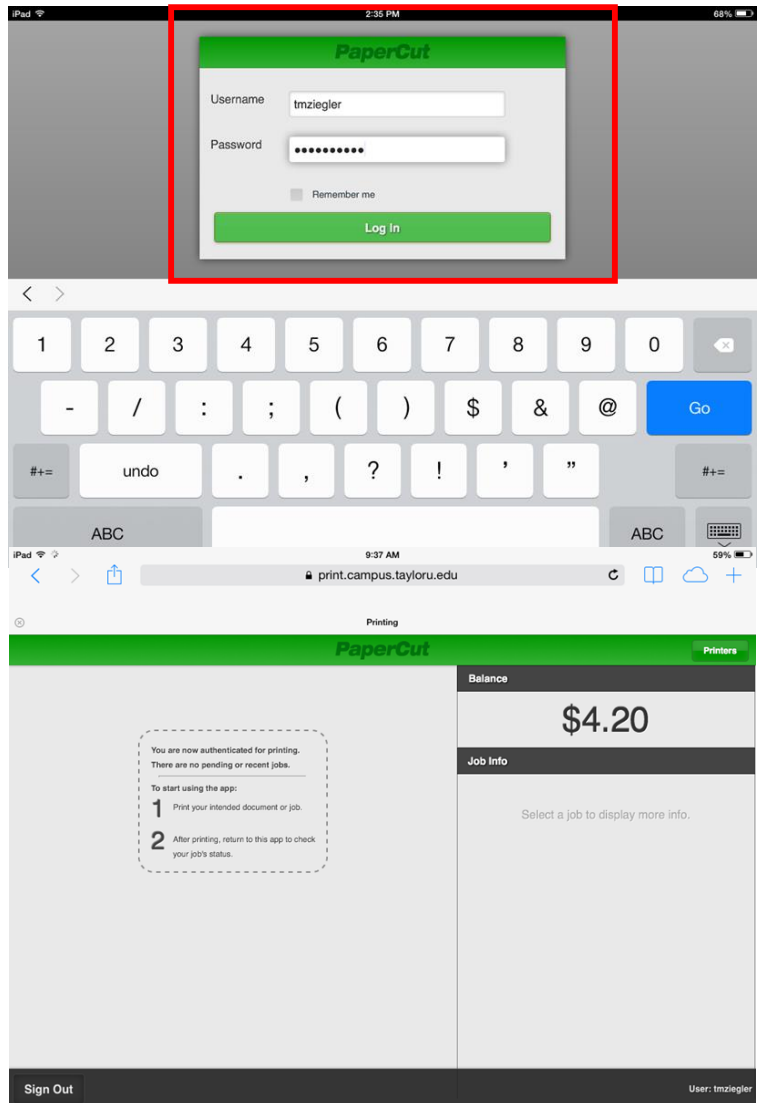

- Verify your username to make sure you've logged in successfully

- The PaperCut Application must remain open for printing to work

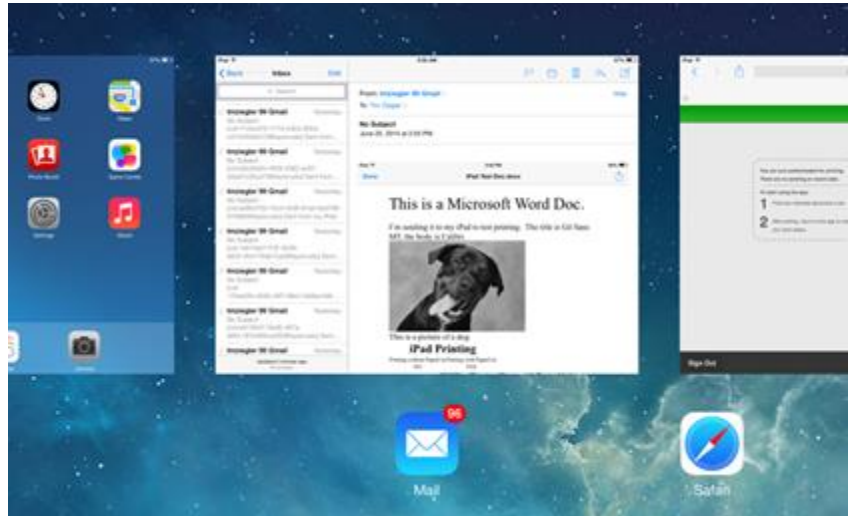

- Switch to any print enabled application
- Locate and press the print option (location and appearance varies by application)

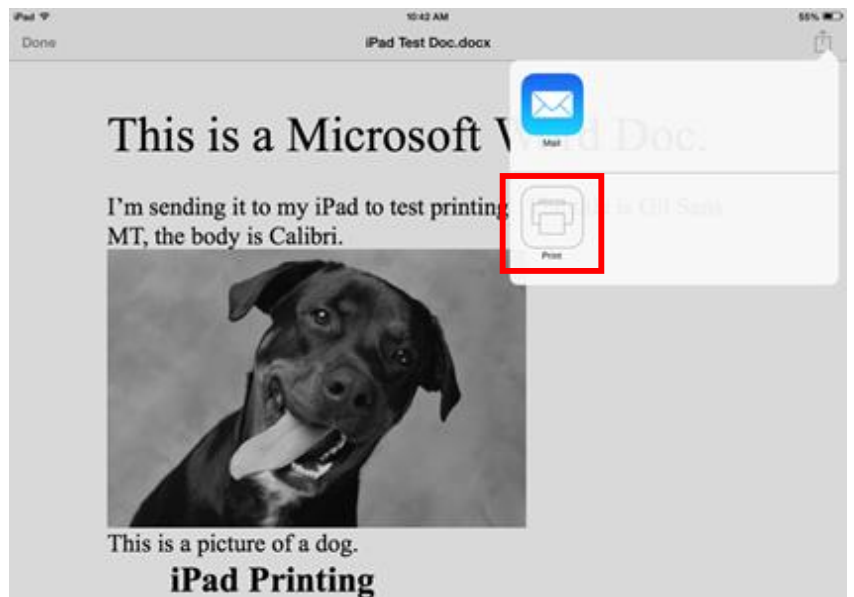

- Press Select Printer



- Select a printer in your area. After selecting one, the printer will appear in the Recent Printers list.



- Add copies if necessary
- Press Print

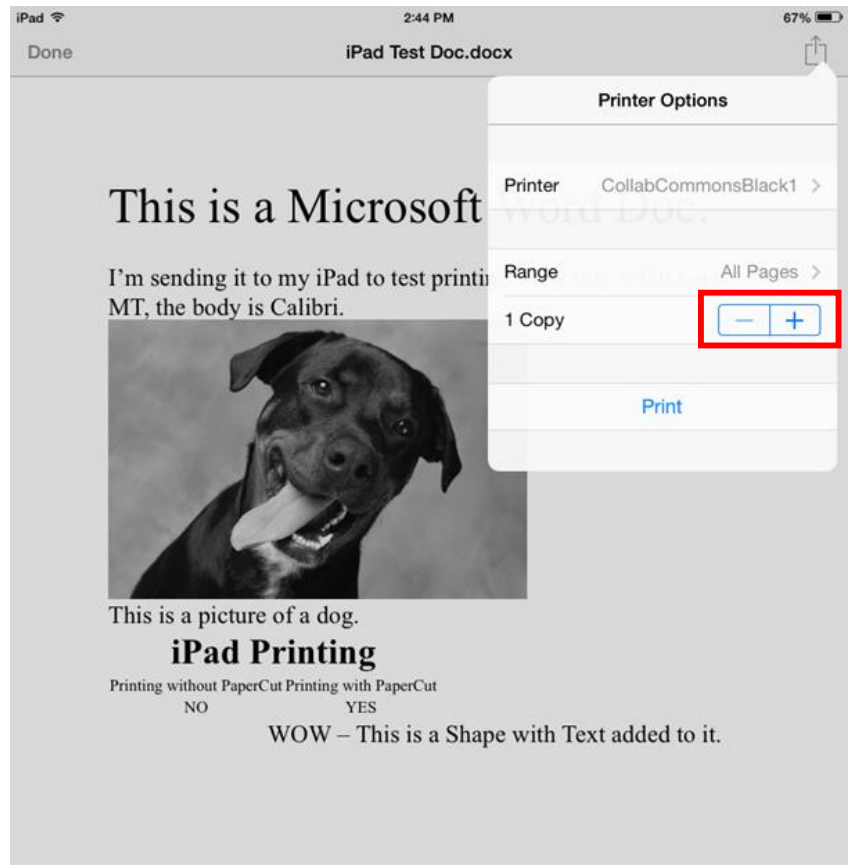

- Switch back to PaperCut
- Select from the options presented
- Press OK
 - Duplex: double-sided
 - Simplex: single-sided
 - Greyscale: black and white print
 - Color: color print.

Note: not all Taylor printers are color-capable.

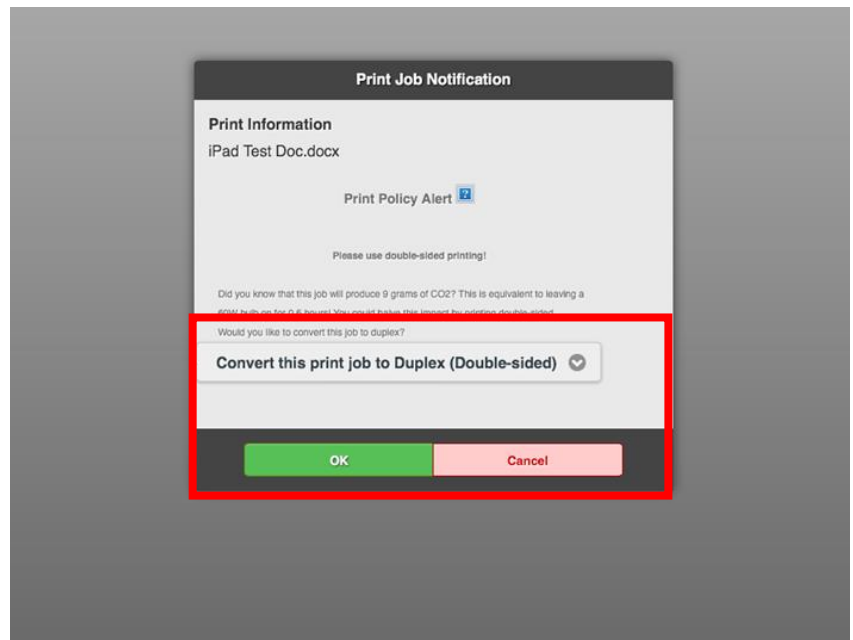

Notes:

Installation and use of the PaperCut application is only possible when connected to Taylor’s T.U.C.A.N. network. To Remove the PaperCut application, press and hold the PaperCut icon, then press the X to confirm deletion.

Documents created on other devices may not print as expected. The document will print exactly as it appears on the iPad screen. If you wish to keep fonts, tables and other items, try converting to another format or snipping a jpg for iPad use.

Original document created on a PC:



Document as viewed and printed with iPad:

